

Boardwalk

Bruce Avenue

GREENBANK

APPROXIMATE FLOOR AREA
106.6 SQM / 1147 SQFT

BOOK A VIEWING

01174 532 985

hello@boardwalkpropertyco.com



GROUND FLOOR
421 sq.ft. (39.1 sq.m.) approx.



1ST FLOOR
418 sq.ft. (38.9 sq.m.) approx.



2ND FLOOR
308 sq.ft. (28.6 sq.m.) approx.

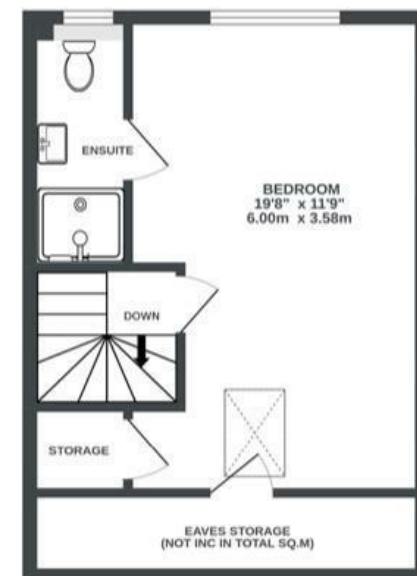

Illustrations are for reference purposes only, measurements are approximate, not to scale.

Boardwalk

Bruce Avenue

GREENBANK, BRISTOL



£435,000



Bristol, BS5

6FF



3 Bedrooms



2 Bathrooms

"Our time living on Bruce Avenue has been wonderful. The street is a strong community, we often enjoy evening drinks in the summer sun together and have an annual street party. The location has provided the best of both worlds, with proximity to beautiful green spaces such as Greenbank Cemetery and the river at Eastville Park, whilst also being only a ten minute cycle to the centre and Temple Meads. The local amenities offer a great choice of independent shops and eateries and the diverse, friendly community makes Greenbank a fantastic place to live. We are only a few minutes walk from brilliant Whitehall Primary School, which makes the morning commute really easy. We will really miss the area and all it offers."

